

AGEING INTO THE 21ST CENTURY

AN ALASKAN CRUISE

WHEN

27th May -
3rd June 2018

VENUE

Celebrity Cruise
Ship "Infinity"

WHERE

Cruising the
Hubbard Glacier

BOOKINGS

Call 0266742577

EDUCATION COMPONENT

info@nursesfornurses.com.au

07 4151 3884 | www.nursesfornurses.com.au

TRAVEL COMPONENT

info@traveldirectaustralia.com.au

02 6674 2577 | www.educationatsea.com.au



"What does the future look like as the population ages into the 21st Century and what are the implications for health care delivery?"

This conference will offer the opportunity to discuss what ageing will look like into the 21st century and how healthcare services will be delivered. For Nursing, in particular, it will provide a platform to explore how Nursing services across the health care spectrum may alter.

As a continuing professional development (CPD) activity the content is relevant to nearly all areas of Nursing as the way in which we provide care as the population ages will impact not only aged care services but also acute care, community care, public health, mental health, and education institutions. As a profession, we need to be ready to embrace the changes that will occur.

- Will research and science mitigate the current issues associated with chronic disease?
- Will public health initiatives lead to disease prevention and a healthier older population?
- Will residential aged care be delivered as it is now in an institutional setting or
- Will robotics play a role in care delivery and technology allow people to remain supported at home?
- Will the Baby Boomer generation redefine the concept of customer service in the healthcare industry and will Nursing, as a profession, be able to adapt and change to meet these expectations?

The Conference Themes:

- Impact on acute health service delivery – what are the current issues in providing services to older people now and what might those services look like in the future? Is there a need to change?
- Chronic disease management – what are the current issues in providing services to older people now and what might those services look like in the future? Is there a need to change?
- Impact on mental health services - what are the current issues in providing services to older people now and what might those services look like in the future? Is there a need to change?
- Impact on the aged care industry in Australia - what are the current issues in providing services to older people now and what might those services look like in the future? Is there a need to change?
- Impact on community-based services including general practice and public health services - what are the current issues in providing services to older people now and what might those services look like in the future? Is there a need to change?
- Impact on Education Institutions – how do we currently educate Nurses and what might future education requirements look like. What will the role of the Nurse be in health services delivery?

The Presenters

Cheryl Dezotti

R.N., M.Q.I.H.C., Grad Dip Q.I.H.C., A.F.A.A.Q.H.C., M.A.C.N.

Cheryl Dezotti is a Registered Nurse and holds a Masters Degree in Quality in Healthcare. Cheryl has worked in both the acute and aged care sectors as a clinician and extensively in healthcare education and management. Cheryl is co-founder and Director of the Nurses for Nurses Network.



She has extensive experience in the application of Quality methodologies to meet the accreditation criteria created by government agencies in the acute and aged care sectors.

In her role as Assistant Director of Nursing & Quality Manager of a medium sized private acute hospital, Cheryl was central in the application of the EQUIP criteria required for accreditation by the ACHS and led the facility in the implementation of medical clinical indicators which was a central part of the accreditation process. The Hospitals Quality Program was recognised by the Australian Private Hospitals Association via a national award for Quality and Excellence

She has been appointed Clinical Advisor and Administrator for aged care organisations that have been sanctioned, along with being an Aged Care Accreditation Assessor and working as an Executive Manager and Facility Manager of Aged Care Facilities.

This experience has allowed her to explore the healthcare accreditation processes from both sides of the divide and she is happy to share her views as to whether the process of accreditation leads to enhancing the experience of the service provided to the patient/client/resident.

Christy Hunt, R.N.

Christy has over 20 years' experience as a Registered Nurse in Health Management and Nurse Education. She currently holds the position of State Manager within IPN/Sonic Health Care for General Practice sites in Tasmania.

Christy has extensive backgrounds in nurse education and has held the positions of General Manager Vocational Education and Training, Nurse Educator and Nurse Management roles in Aged Care and General Practice.



Christy has a passion for workforce development, education and career progression for nurses. She started her educational career as a teacher in the Nursing sector and has progressed to a number of senior roles and held a number of Non-Executive Director Board roles that have a specific focus on increasing the prospects of health provision and education within disadvantaged groups. The roles have included working with NGO's, State-Based Boards, Ministerial Taskforce initiatives and the Collective Impact 2030 Initiative.

Christy has a focus on increasing service provision and improving care initiatives in the Primary Health and General Practice area. Her role in Sonic Health Services will have a key coordination and implementation component for the implementation of Health Care Homes (HCH) Models in the General Practice area.

Margaret Purdy

Margaret completed her basic Nursing training in the UK (before time began), prior to migrating to Australia. She has worked in all clinical areas during her “nursing life”



Margaret's primary interest was in acute medical Nursing and rehabilitation. She has held the roles of Clinical Nurse Specialist, Nurse Unit Manager in the acute medical setting and Senior Nurse Manager in a rehabilitation and transitional aged care unit.

Margaret's “teaching life” began after retirement and she has taught theoretical components and clinical skills to Certificate III Aged Care workers and Enrolled Nurses both at the Endorsed Enrolled Nurse level and at the Diploma of Nursing level.

Margaret's favourite subjects to teach are anatomy and physiology and wound management, both of which she is currently teaching. Margaret continues to work as a Facilitator for the students during clinical placements in the acute and aged care settings.

Pam Bridges

During her career, Pam has worked in a wide range of roles including (but not limited to):

- Community Nursing
- Operations Manager TARCAC
- Commonwealth Nursing Officer
- Manager Residential Care
- Residential Care Manager (ACQI)
- Manager ACQ Consultancy Services
- Manager Residential Services – 5 Facilities



Pam is a Registered Nurse BA (Social Welfare), Graduate Diploma (Health Services Management) and an Aged Care Quality Assessor. She has been involved with a wide range of State and National Committees and Reference Groups representing industry views and interests on behalf of the ACQ (LASA Q) membership. Pam is also included on the Department of Health and Ageing Nursing Advisor and Administrator Panel.

Pam's wide-ranging career experiences have enabled her to network with Nurses across Australia and across all streams i.e. retirement living, community and residential.

In her spare time, Pam has been President (an honorary position) of Nurses in Management Aged Care (NIMAC) for the past fifteen years. This is a professional development, peer support association and network for those working in the aged care sector in management positions. She hosts a very successful annual conference each year, and for the past two years has led study tours to the Netherlands and Singapore (2011), and Philadelphia and Los Angeles in the USA (2012). These tours are an opportunity to compare the provision of aged care in a number of countries other than Australia.

Dr Pam Savage

Pam has an extensive background in clinical nursing, education, and remote area Nursing both in Australia and overseas. As a Lawyer and Clinician, this background is brought to her role as adjunct Lecturer to undergraduate and postgraduate students as well as Aboriginal Health Workers.

Pam is a Barrister at Bar (NSW) and a published author and her book "Law for Student Nurses: applied principles" is now in its third edition.



Sue Walker

R.N. Bach Nursing (Administration), M.P.H.C. (Palliative Care)

Sue is a co-founder and Director of the Nurses for Nurses Network, and is passionate about making a difference to the way in which people experience the healthcare system. Healthcare should be delivered by competent, knowledgeable individuals to ensure the best possible experience for the recipient of that care.

Nursing is a fabulous profession - the backbone of the healthcare system, in co-founding the Nurses for Nurses Network her aim is to provide a platform for her nursing colleagues to enhance their knowledge and share their specialist skills with other nurses.

Sue has worked in a number of clinical practice areas her most recent clinical experience being in the aged care sector as both a clinician and a manager.

During the time she worked as a Nurse Consultant for Health Services Evolution, the aim was to provide an education and quality monitoring system that was useful and relevant to those that work in the aged care industry. "We measure financial performance but rarely take the time to review the care indicators that reflect the core business of the industry."

Sue continues to believe that the use of quantifiable clinical care indicators, monitored by an independent external agency, in the aged care industry would lead to a much better service delivery model.



This Conference is supported by the
International Federation on Ageing

DAY 1: 27 MAY 2018 | DEPART VANCOUVER

1700 - Conference Registration

DAY 2: 28 MAY 2018 | CRUISING THE INSIDE PASSAGE

0900: Welcome to Conference

0910 – 1100: The Longevity Revolution | Sue Walker | FF

We will explore what the future of ageing will look like and with that knowledge reflect on the possible impact on health service provision.

In this session you will:

- Explore the concept of the right to age well
- Gain an understanding of what the new life course looks like
- Investigate the concept of active ageing
- Consider health policy to meet the expectations of the revolutionaries

1100 - 1200: Reinventing What Home Means: Both in the Residential and Home Care Settings | Pam Bridges | W

It used to be so simple - residential care; community care and retirement villages. Not so anymore with services apartments; apartments for life; capacity to buy in services but remain in the home. This session will look at how things are changing.

In this session you will:

- Explore what are the current housing models
- Investigate what consumers are looking for
- Consider how can we assist people to prepare to remain in their chosen location
- Reflect on how we would need to change current practice

1200 - 1300: Lunch

1300 - 1400: The Demographic Facts of Ageing in Australia | Sue Walker | W

There is now widespread recognition that Australia's population is ageing and that this has important implications for the national economy and society. Despite this, there is a considerable misunderstanding of the nature, scale, location and implications of population ageing in Australia.

In this session you will:

- Gain an understanding of the growth of Australia's older population over the next two decades
- Explore the size and characteristics of Australia's future older population
- Investigate if geography will play a role in service delivery
- Reflect on how we can plan to deliver health services especially nursing services

1400 - 1600: Coaching and Mentoring - Creating the Health Care Workforce of the Future | Pam Bridges | FF

Our pool of potential staff is diminishing. Various generations view the term work ethic very differently.

In this session, you will:

- Explore mentoring - What it is and what it is not?
- Consider the mentoring relationship – including rapport building, direction setting, up-skilling identification and training
- Investigate Mindful Leadership, building great teams, and defusing disruptive behaviour
- Review the key aspects of performance appraisal



FF - Face to face

W - Webinar

SD - Self directed

COSTS

CONFERENCE REGISTRATION

NfN Members

\$845 .00

Non Members

\$945.00

CABINS

Contact Travel Direct Australia

02 6674 2577

OPTIONAL TOURS

Icy Strait Point

Juneau

Contact Travel Direct Australia

02 6674 2577

Please note the prices stated above are for the education component only. Please contact the team at Travel Direct Australia for further information regarding the travel component.

Juneau



1600 - 1700: Outthink Ageing | Sue Walker | SD

In this session, we will explore the ability of technology to empower us to live longer, healthier, more independent lives. Technology does not replace the human element, but it's a tool that will enable the growing ageing demographic and their caregivers to better their lives.

In this session, you will:

- Explore the impact of technology on health in general
- Investigate how technology can assist in keeping the person connected to both family and community
- Consider the impact of technology on security
- Reflect on how technology can enhance the dignity of the individual

DAY 3: 29 MAY 2018 | ICY STRAIGHT POINT, ALASKA

0900 – 1000: The rise of the Nurse Practitioner and Beyond Cheryl Dezotti | W

The Nurse Practitioner role within the healthcare industry is continuing to evolve along with the public's perceptions of Nurses and their role within the healthcare system.

In this session you will:

- Become familiar with the history of the evolution of the Nurse Practitioner role
- Explore the impact that the Nurse Practitioner role has on Client Service Delivery
- Reflect on the diversity of Nurse Practitioner roles throughout the world
- Consider the potential for the extension of this role in the future

1000 – 1100: Yesterday, Today and Tomorrow: The Evolving role of the Enrolled Nurse | Margaret Purdy | FF

The role of the Enrolled Nurse has rapidly changed over the last three decades and in the future, can only be one of utmost importance in the delivery of quality care to our older people.

In this session you will:

- Gain an understanding of the history of the role of the Enrolled Nurse
- Explore the issues surrounding the practice of the Enrolled Nurse today
- Investigate the potential use of this skilled health professional
- Reflect on the planning and staffing of nursing services into the future

1100 – 1200: Adapting to the Changing Initiatives for General Practice Nursing | Christy Hunt | FF

The question for General Practice is how can nursing staff be utilised more proficiently, working to the full extent of the scope of practice guidelines and ensure that patients are informed, well educated, engaged and moving towards improvements in health.

In this session you will:

- Explore the Health Care Homes (HCH model)
- Gain an understanding of the role of the Practice Nurse within this model
- Investigate workforce education and planning requirements
- Reflect on future developments in the role of the Practice Nurse



CELEBRITY INFINITY

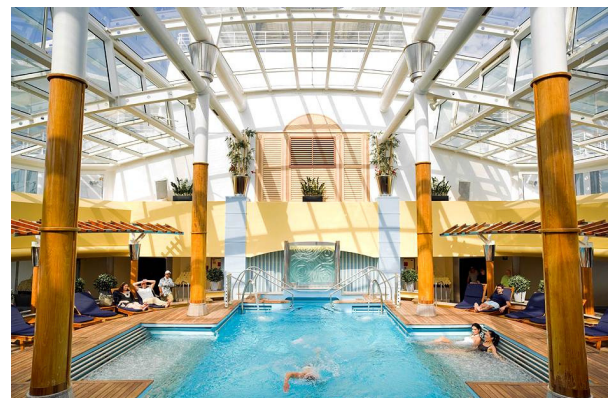

1200 – 1300: Nursing - Challenges and Expectations into the Future | Pam Bridges | W

Registered staff are struggling with the models of care being introduced in the present aged care sector and the impact this will have on their practice/s. This session will examine the challenges that are emerging.

In this session you will:

- Explore the models of care in the aged care sector and what is changing
- Investigate how might this impact on the Scope of Practice responsibilities of registered staff
- Consider what might the Implications for future staffing models be
- Reflect on future career planning

1400 - Optional Tour Available

DAY 4: 30 MAY 2018 | THE HUBBARD GLACIER

0900 - 1000: The Smart Home and Wearable Technologies Cheryl Dezotti | W

Technology impacts everyday life and Healthcare innovations are advancing rapidly in the areas of monitoring and directly assisting with health care delivery to clients.

In this session you will:

- Explore the elements of the 'Smart Home'
- Gain an awareness of the myriad of wearable technologies being introduced to assist with client/ patient care
- Consider the benefits and limitations of wearable health-related technology
- Reflect on the related implications for the role of the Nurse

1000 – 1100: World Innovations for Australia to Consider - How other Countries are Delivering Healthcare to their Ageing Populations | Cheryl Dezotti | W

8.5% of people worldwide (617 million) are aged 65 and over. This percentage is projected to jump to nearly 17% of the world's population by 2050 (1.6 billion). "An Ageing World: 2015,"

In this session, you will:

- Review the health care system implications of an ageing population
- Explore how different nations are planning for the management of their ageing populations
- Reflect on innovative methods of health care delivery models for the older person
- Consider service delivery models that could be effectively employed within the Australian setting

1100 - 1200: The Future of Wound Care Management for an Ageing Population | Cheryl Dezotti | W

The ageing population is at increased risk of wounding due to a myriad of intrinsic factors. Wound management must continue to evolve to cater for an ageing population where human and fiscal resources are limited.

In this session you will:

- Review the variables of the ageing person which increase their risk of both wounding and delayed healing
- Explore wound management products that are being created to assist with effective wound management in the ageing person



CELEBRITY INFINITY



Ageing into the 21st Century

29 CPD Hrs

- Consider strategies to effectively reduce the incidence of wounding in the ageing population
- Reflect on practical ways that Nurses can influence timely and appropriate wound management care for an ageing population

1200 - 1300: Lunch

1300 - 1400: Attitudes Towards Ageing | Dr Pam Savage | W

Ageism can be described as 'a process of systematic stereotyping of, and discrimination against people' simply because they are older. While ageism conflicts with the philosophy of nursing there is evidence that some nurses and students of nursing hold negative attitudes towards the elderly.

In this session you will:

- Recognise how stereotyping can lead to discrimination of the aged
- Relate principles of the Aged Discrimination Act to nursing responsibilities
- Appreciate how negative attitudes may directly influence care
- Identify knowledge deficits that significantly influence nurses' practice and older patients' quality of care.

1400 - 1500: An Ageing Australia: Preparing for the Future Sue Walker | SD

Australia's population will both grow stronger and become older. Such slow but profound shifts in the nature of a society do not elicit the same scrutiny as immediate policy issues. The preferable time to contemplate the implications is while these near-inevitable trends are still in their infancy.

In this session you will:

- Explore how ageing will affect labour supply, economic output, infrastructure requirements and governments' budgets
- Investigate social and economic change to the aged pension and housing
- Consider the implications for health service delivery
- Discuss what needs to happen so that services can be planned effectively

DAY 5: 31 MAY 2018 | JUNEAU

0800 - Optional Tour Available

Today you will have the opportunity to see humpback whales up close and personal and venture on shore to explore the beautiful town of Juneau.



Smart Home

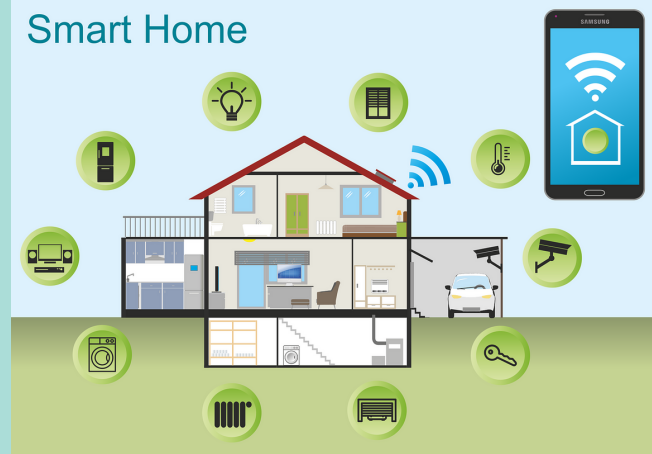

OPTIONAL SHORE TOURS

Icy Strait Point, Alaska

Icy Strait Point is Alaska Native owned-and-operated, with all profits directly supporting the community of Hoonah, Alaska's largest Native Tlingit village.



Juneau, Alaska

Juneau, Alaska's remote capital, sits in the state's panhandle, at the base of 3,819-ft. Mount Roberts.



DAY 6: 1 JUNE 2018 | KETCHIKAN, ALASKA

0800 – 0900: Consumer Directed Care - What this means Pam Bridges | SD

Consumer directed care (CDC) has been implemented in the home care marketplace and reforms around regulatory requirements strengthened in early 2017.

In this session you will:

- Examine the challenges of implementing this model and maintaining a competitive advantage
- Explore consumer-directed care in the home care setting
- Investigate the move to implement consumer-directed care in the residential care sector
- Gain an understanding of what this mean for providers and consumers

0900 – 1000: Elder Abuse: Understanding and Preventing. Is it a Nurses role? | Dr Pam Savage | W

Available data indicates that between 2-5% of Australians over the age of 65 years have experienced abuse, that up to 80% of perpetrators are family members of the victims (the large majority being their children). That financial and psychological abuse are the most common forms of abuse, and that women are twice as likely to be victims of abuse. Nurse's need to recognise their responsibility to advocate and protect the vulnerable in our society.

In this session you will:

- Relate nursing ethical standards to needs of the vulnerable aged
- Understand the legal and social requirements in protecting the aged in Australia
- Recognise the signs of elder abuse and reporting requirements
- Understand and address causal factors that underpin aggression towards aged clients

1000 – 1100: Do Robotics have a Future in the Aged Care Space? | Pam Bridges | FF

Technology is progressing at amazing speeds. Have you considered what this might mean for your services?

In this session you will:

- Gain an understanding of the availability of robots
- Explore what their capabilities are
- Discuss the Case study presented from the Dutch Village
- Review the implications for the provision of Nursing Service



OPTIONAL SHORE TOURS

Ketchikan, Alaska

Ketchikan is an Alaskan city facing the Inside Passage, a popular cruise route along the state's southeastern coast. It's known for its many Native American totem poles, on display throughout town.



1200 – 1300: Robotics in the community - How we can Support the Ageing Person at Home | Pam Bridges | FF
More and more people are opting to remain in their own home and receive services there. This session will look at developments that will enable people to maintain their independence for as long as possible.

In this session you will:

- Explore robotic technology and the types of Robotics available
- Review overseas trends
- Investigate if this technology being used in Australia
- Examine the success of robotics and what the future may hold

1300 – 1400: Ageing and the Health System: Challenges, Opportunities and Adaptations | Sue Walker | SD

There is concern that this ageing of the population will put unsustainable pressure on public spending, with particular concerns about rising health costs and the ability of the health system to serve the increasing numbers of older people needing care. These issues are discussed at some length in this article.

In this session you will:

- Explore the challenges to the health care system
- Investigate how disability could impact on service requirements
- Consider the gender differences in life expectancy and the social impact of same
- Review how we as health workers can encourage healthy ageing in our clients

1400 Explore the town of Ketchikan at your leisure

DAY 7: 2 JUNE 2018 | THE INSIDE PASSAGE

0900 - 1000: Who's Monitoring What in the Healthcare Services of Australia – Let the Madness Unfold | Cheryl Dezotti | W

There are a plethora of accreditation and monitoring agencies that review different aspects of Australian Health Care Services. How effectual are they?

In this session you will:

- Receive an overview of the key accreditation and monitoring bodies that review Australian Health Care Delivery Services
- Discuss the costs associated with these external bodies
- Explore whether these external bodies do markedly influence the quality of care and services the client receives
- Reflect on ways the 'system' could be improved to facilitate better health outcomes for the end user of the Australian healthcare system

1000 – 1100: Measuring Quality Service Provision | Pam Bridges | FF

This session will look at what are the key indicators that will measure quality service provision in the future. Are you still conducting audits but not using the data to 'value-add'?

In this session you will:

- Review the regulatory requirements for aged care services
- Consider consumer expectations and changing models of care



THE INSIDE PASSAGE

The Inside Passage is a coastal route for oceangoing vessels along a network of passages which weave through the islands on the Pacific coast of North America.

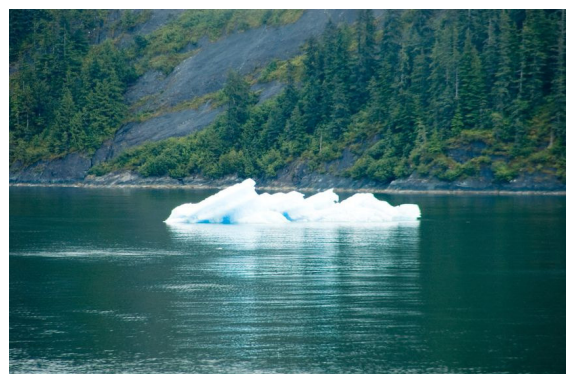

- Explore the critical areas that an ongoing audit schedule should cover
- Investigate how we involve consumers and their representatives in the process

1100 - 1200: The Role of Management in the Delivery of Quality Services of Healthcare in Australia | Cheryl Dezotti | FF

This session will evaluate the role of management in the delivery of quality health care services according to the Australian Safety and Quality Framework for Health Care. Note that management refers to all persons within the health service who can influence service delivery from the Director of Clinical care to the Nurse Team Leader in charge of a shift.

In this session you will:

- Gain an understanding of the core principles of providing safe and quality care
- Explore the role of management in delivering health services that exceed customer expectation
- Examine the ways in which management can create an environment where staff want to achieve
- Reflect on the situation within your own organisation

1200 - 1300: Lunch

1300 – 1400: The Architecture of Health Care Delivery | TBA | W

The built environment has a huge influence on how health care is delivered. This influence is felt by all those individuals who utilise the building – staff, clients, and visitors. In this session, we will explore the impact of the built environment.

In this session you will:

- Gain an understanding of the current philosophy that underpins health care facility design
- Explore the impact of the built environment on the users of that building
- Examine design elements that have got it right
- Reflect on what the health care facility of the future could look like

1400 – 1500: How will Service Providers Monitor if their Services are Hitting the Spot? | Pam Bridges | FF

Aged care services are becoming more and more competitive and to ensure that a service can maintain its market share managers and staff need to know what consumers want and/or expect.

In this session you will:

- Investigate what the baby boomer generation wants
- Explore how this differs from traditional approaches to the provision of historical aged care services
- Consider how age care service providers ensure that their services meet the expectations of clients
- Discuss how this competition will impact on services provided



THE HUBBARD GLACIER

Hubbard Glacier is a glacier located in eastern Alaska and part of Yukon, Canada, and named after Gardiner Hubbard. Wikipedia

Length: 122,000 m

Location: Yakutat City and Borough, Alaska, U.S., Yukon, Canada

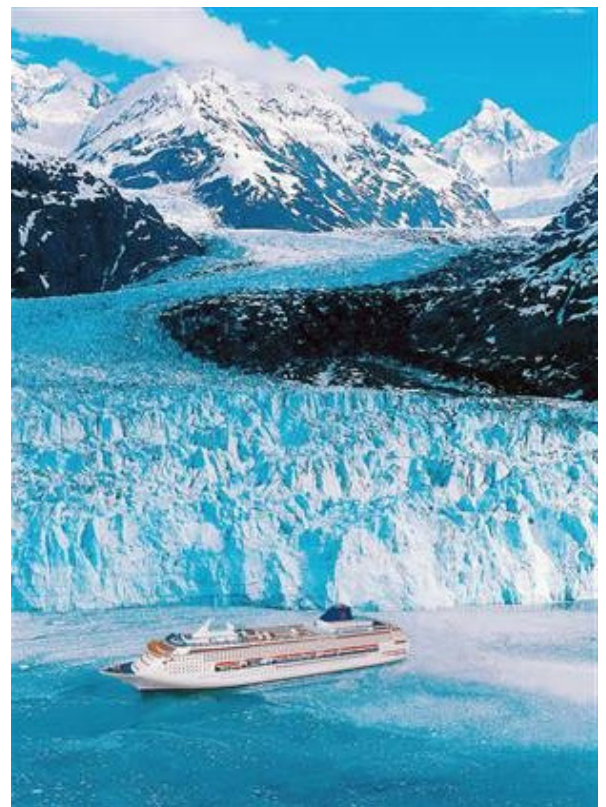

1500 – 1600: Open Panel Discussion on Quality in Health Care Cheryl Dezotti, Pam Bridges, Sue Walker | FF

In this interactive session, the panel will discuss the issues that they believe will be the greatest influence on health care delivery for both the recipient of health services but also the Nursing staff involved in their delivery. Participants are encouraged to participate in the discussion.

1600 – 1700: Quality Standard Reforms - Where are we going? Pam Bridges | SD

Consumer directed care (CDC) is being considered for implementation in the residential sector. This has led to a Common set of Standards taking the place of the residential care quality standards and the home care standards. This session will look at how both sectors are managing the changes.

In this session you will:

- Explore progression towards a common set of standards
- Investigate the changing processes by the Standards Agency to capture the consumer experience
- Review what might this mean for the providers of aged care services
- Reflect on how Nursing services may be organised to meet these changing requirements

1800: Farewell Reception

DAY 8: 3 JUNE 2018 | ARRIVE VANCOUVER

Disembark - safe travels!



Disclaimer: The opinions and statements of facts expressed by the Presenters in these proceedings are those of the Presenters and do not necessarily represent those of the Nurses for Nurses Network, the editors, the organising committee or the supporters of this Study Tour. No responsibility can be accepted by the Study Tour organisers for errors or omissions in the individual presentations. Sessions are correct at time of publication. Sessions are subject to change without notice due to circumstances beyond the control of the Conference organisers



CONFERENCE PARTNER



EDUCATION *at* SEA

To register your booking online kindly complete a booking enquiry form. Please include your cabin preference. For further booking information please contact Helen, Elita or Jason at Travel Direct Australia on 02 6674 2577.

If you would like further information about a conference or seminar online please complete a booking inquiry with your questions within the enquiry area.

